



R9 SERIES
MODEL R93150A

MAX. PRESSURE – 125" H₂O (60 Hz), 125" H₂O (50 Hz)
MAX. VACUUM – 115" H₂O (60 Hz), 105" H₂O (50 Hz)
MAX. AIR FLOW – 680 CFM (60 Hz), 585 CFM (50 Hz)

PRODUCT FEATURES

- Rugged construction, low maintenance
- Oilless operation
- UL and CSA approved TEFC motor with permanently sealed ball bearings
- IP54 rated enclosure on motors
- Cast iron housing, cover and muffler enclosure. Cast aluminum impeller
- Inlet and outlet have internal muffling

RECOMMENDED ACCESSORIES

- Pressure gauge AE133
- Inlet filter AJ126M (pressure)
- Vacuum gauge AE134
- Vacuum gauge for monitoring inlet filter restriction AJ497
- Pressure/vacuum relief valve AG258F
- Silencer for vacuum relief valve AJ121G
- Inline filter AJ151M (vacuum)
- External muffler for additional silencing AJ121H
- Foam replacement kit K829



Product Dimensions (in. mm)

Note: Unit must be mounted with shaft horizontal.

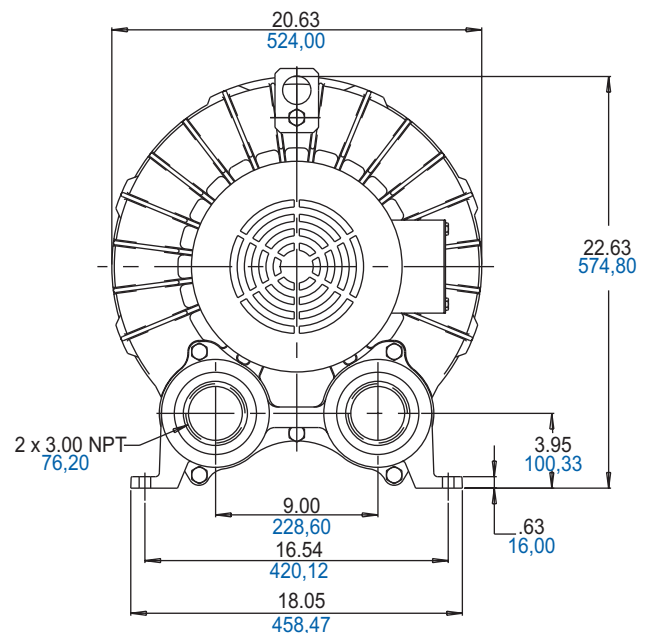
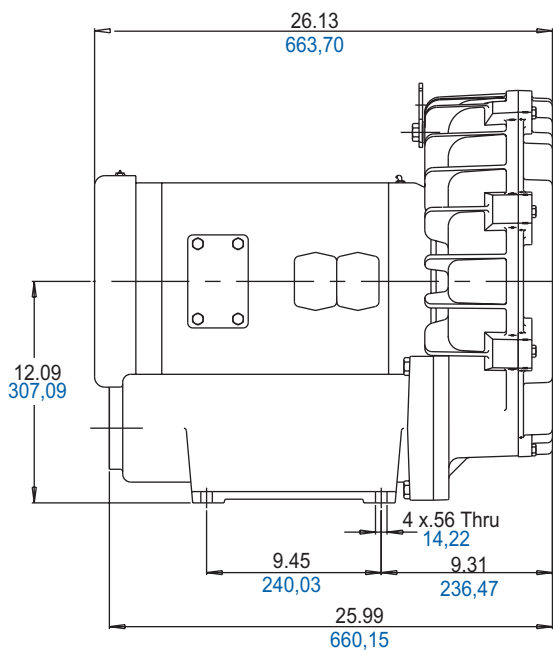



Product Specifications

MODEL NUMBER		R93150A
Motor Enclosure		TEFC
HP/kW	60 Hz	15/11,1
	50 Hz	10/7,5
Voltage	60 Hz	208-230/460-3
	50 Hz	190-220/380-440-3
Amps	60 Hz	50-50/25
	50 Hz	46-42/23-21
Starting Amps	60 Hz	173 @ 460V
	50 Hz	185 @ 440V
Insulation Class		F
Recommended NEMA Starter Size		2/2
Net Weight (lbs/kg)		452/204

Product Performance

